

**PLAN**  
Scale 1"=40'

**PROFILE LEGEND**  
Approximate Present Surface of Ground shown by Black Line thus, ———  
Flow Line of Sewer to be Constructed shown by Red Line thus, ———

**NOTE**  
All Whipped Pipe Sanitary Sewer shall be constructed at an upward grade of two (2%) cent from the Main Sewer and shall extend from the Main Sewer to a point 50' from Center Line of Street.

**PROFILE LEGEND**  
Approximate Present Surface of Ground shown by Black Line thus, ———  
Flow Line of Sewer to be Constructed shown by Red Line thus, ———

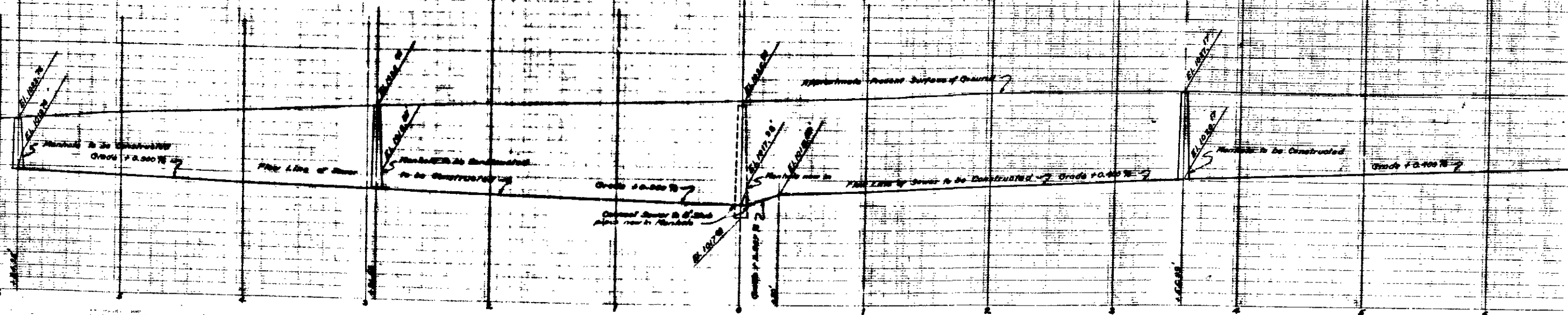

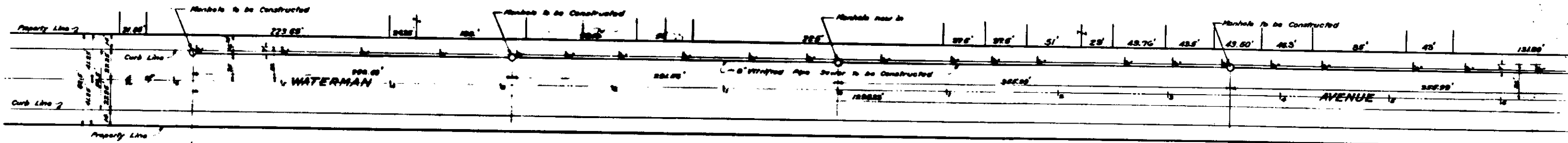

**PLAN**  
Scale 1" = 40'

**PROFILE LEGEND**  
Approximate Present Surface of Ground shown by Black Line thus, ———  
Flow Line of Sewer to be Constructed shown by Red Line thus, ———

**NOTE**  
All Whipped Pipe Sanitary Sewer shall be constructed at an upward grade of two (2%) cent from the Main Sewer and shall extend from the Main Sewer to a point 50' from Center Line of Street.

**PROFILE LEGEND**  
Approximate Present Surface of Ground shown by Black Line thus, ———  
Flow Line of Sewer to be Constructed shown by Red Line thus, ———

